

Orientation

Key Plan

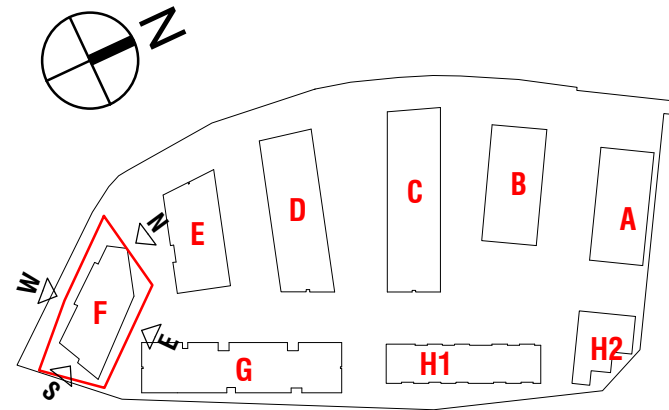

Block F East Elevation  
1 : 200



Block F South Elevation  
1 : 200



Block F West Elevation  
1 : 200



Block F North Elevation  
1 : 200

P04	04.02.22	Amendments to planning drawings issued on 26.03.21	SM	AR
P03	26.03.21	Amendments to planning drawings issued on 05.04.19	SS	AR
P02	08.07.19	Amendments to planning drawings issued on 05.04.19	SM	AR
P01	05.04.19	Updated information for planning issued on 28.05.18	SM	AR

Rev. Date	Revision	By	Checked
-----------	----------	----	---------

**leonard** design architects  
4th floor, Albion House  
5-13 Canal Street  
Nottingham, NG1 7EG, United Kingdom  
t. +44 (0) 115 945 0080  
e. office@leonarddesignarchitects.com

**Client**  
Reuben & Morgan Ltd.

**Project**  
West Quay Road, Poole

**Drawing Title**  
Block F Elevations

<b>Project Number</b> 0625	<b>Suitability</b> S4
<b>Drawn by</b> LW	<b>Checked by</b> SM
<b>Scale @A1</b> As indicated	<b>Date</b> 05.04.19
<b>File Identifier</b> 0625 - LDA - ZZ - ZZ - DR - A - 08075	<b>Revision</b> P04

**Purpose of Issue**  
PLANNING

**Project Status**  
PLANNING

